

# V BOLTS

MS = Mild Steel Bolt Grade 43A

HT = High Tensile Bolt Grade EN16T

Finish = Spun Galvanised to BS 7371

Each Supplied with 4 Full Nuts, 2 Flat Washers and 2 Spring Washers

Part No MS	Part No HT	C	L	D	T	L1	Size	Series
2/VB/5039	-	72	97	10	63	-	20-60mm	N/A
2/VB/001	-	42	60	12	35	-	25mm	N/A
-	2/VB/12/0020	75	130	12	92	103	42mm - 60mm	1000
2/VB/2050	2/VB/12/2050	129	175	12	100	115	60mm -114mm	2000
-	2/VB/12/2050/LL	129	220	12	145	160	60mm -114mm	2000
-	2/VB/12/060/060	104	150	12	75	105	60 x 60 angle	1000
-	2/VB/12/100/100	164	136	12	50	60	100 x 100 angle	3000
-	2/VB/12/115/115	185	147	12	50	60	115 x 115 angle	3000
-	2/VB/12/127/127	201	158	12	50	60	5" x 5" angle	4000
-	2/VB/12/150/150	232	165	12	50	55	6" x 6" angle	4000

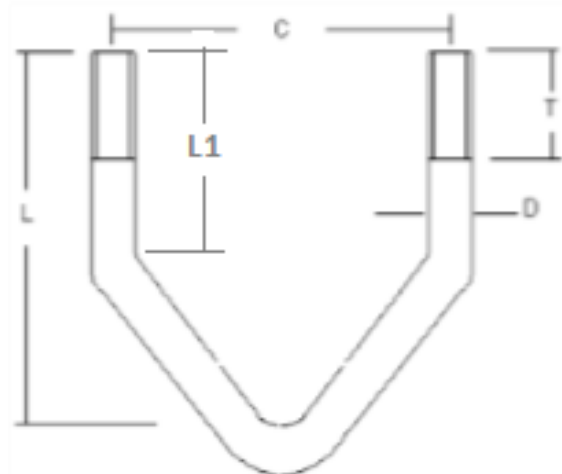

091018